

LEGEND:

| | |
|--------|---|
| 000.00 | EXISTING GROUND SPOT ELEVATIONS (TOPO SURVEY MAY 2012) |
| ○ | EXISTING MANHOLE |
| □ | EXISTING CATCHBASIN |
| ◇ | EXISTING HYDRANT |
| ◇ | EXISTING WATER VALVE |
| HP | EXISTING HYDRO POLE |
| X | EXISTING FENCE |
| — | EXISTING CURB |
| — | NEW CONC. CURB & GUTTER |
| — | NEW CONC. SIDEWALK |
| □ | NEW CATCH BASIN |
| ⊥ | NEW TRAFFIC SIGN POLE BASE (SEE DETAIL 1 DWG D1 FOR DETAILS) |
| ⊥ | NEW TCM TRAFFIC POLE BASE FOR PERMANENT DRIVE FEEDBACK SIGN (SEE DETAIL 2 DWG D1 FOR DETAILS) |

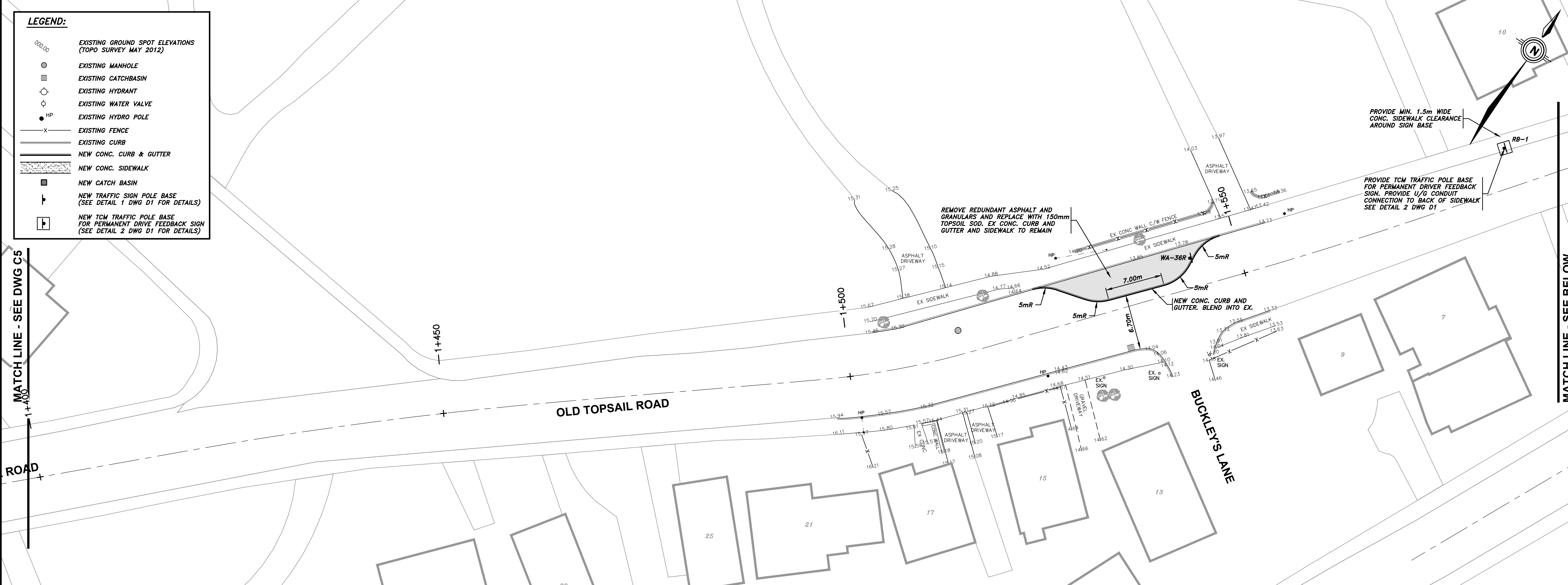

- NOTES
1. TOPOGRAPHIC SURVEY BY CITY ST. JOHN'S FORCES.
 2. ALL WORK TO BE PERFORMED IN ACCORDANCE WITH THE CITY OF ST. JOHN'S SPECIFICATIONS BOOK.
 3. ANY DISTURBED AREAS REQUIRED FOR SIGN INSTALLATION OR MINOR CONSTRUCTION WORK TO BE RESTORED TO ORIGINAL CONDITIONS OR BETTER.
 4. CONTRACTOR RESPONSIBLE TO SECURE WORK AREA DURING CONSTRUCTION FOR TRAFFIC AND PUBLIC SAFETY.
 5. CONTRACTOR TO VERIFY ALL DIMENSIONS AND ELEVATIONS ON SITE BEFORE PROCEEDING WITH THIS WORK. (DO NOT SCALE FROM DRAWINGS).
 6. CONTRACTOR TO ENSURE NO SIGNAGE INSTALLATION OR MINOR CONSTRUCTION WORK OCCURS ON PRIVATE PROPERTY.
 7. CONTRACTOR RESPONSIBLE FOR LOCATING ANY EXISTING UNDERGROUND INFRASTRUCTURE (IE ELECTRICAL, TELEPHONE, WATER, SEWER, ETC.) PRIOR TO INSTALLATION NEW SIGN POSTS TO ENSURE NO CONFLICTS.
 8. CONTRACTOR RESPONSIBLE FOR INSTALLING NEW SIGN BASES & POSTS. CITY OF ST. JOHN'S FORCES TO ORDER AND INSTALL SIGNS ONTO POSTS. CONTRACTOR TO COORDINATE WITH CITY OF ST. JOHN'S FORCES.
 9. SIGNS MAY BE INSTALLED ONTO EXISTING HYDRO POLES OR LIGHT STANDARDS WHERE POSSIBLE. COORDINATE WITH CITY OF ST. JOHN'S.
 10. STREET DIMENSIONS ARE MEASURED FROM FACE OF CURB UNLESS NOTED OTHERWISE.
 11. ALL DISTURBED AREAS BEYOND LIMITS OF WORK TO BE RESTORED TO ORIGINAL CONDITION OR BETTER.
 12. ALL SIDEWALKS TO BE INSTALLED IN ACCORDANCE WITH DRAWINGS 10-330-03, 10-330-04, AND 10-330-11 OF THE CITY ST. JOHN'S SPECIFICATIONS BOOK.
 13. BARRIER FREE CURB RAMPS TO BE INSTALLED AT LOCATIONS SHOWN IN ACCORDANCE WITH ACCESSIBILITY ACT AND REGULATIONS.
 14. ALL NEW LINE PAINTING AND INSTALLATION OF SPEED HUMPS TO BE COMPLETED BY CITY ST. JOHN'S FORCES.



| NO. | REVISIONS | DATE |
|-----|------------------------|----------|
| 1 | REVISED LIMITS OF WORK | 28/05/12 |
| 0 | ISSUED FOR REVIEW | 17/05/12 |

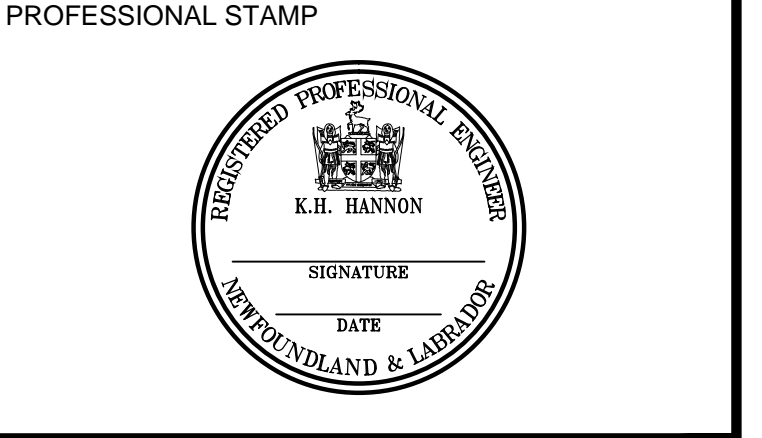

PROVINCE OF NEWFOUNDLAND
 PERMIT HOLDER
 Class 'A'
 This Permit Allows
 PINNACLE ENGINEERING LIMITED
 To practice Professional Engineering in Newfoundland and Labrador.
 Permit No. as issued by APEGN L0331
 which is valid for the year 2012.

| SIGN | IMAGE | SIZE |
|--------------------------------------|-------|-----------|
| TRAFFIC-CALMED NEIGHBOURHOOD *ID-32 | | 600x450 |
| TRAFFIC-CALMED NEIGHBOURHOOD *ID-32S | | 600x225 |
| ADVANCE TURN ARROW RIGHT *IS-6R | | 450x300 |
| "DOWNTOWN" | | 600x225 |
| ADVANCE STRAIGHT ARROW *IS-7 | | 450x300 |
| MAXIMUM SPEED *50 *RB-1 | | 600x750 |
| OBJECT MARKER RIGHT *WA-36R | | 300x900 |
| OBJECT MARKER LEFT *WA-36L | | 300x900 |
| CHEVRON ALIGNMENT RIGHT *WA-9R | | 450x600 |
| YIELD *RA-2 | | 750 SIDES |
| NEIGHBOURHOOD SPEED HUMP *WA-50T | | 450x450 |
| NEIGHBOURHOOD SPEED HUMP *WA-50TA | | 450x225 |
| PEDESTRIAN CROSSWALK RIGHT *RA-4R | | 600x750 |
| PEDESTRIAN CROSSWALK LEFT *RA-4L | | 600x750 |

CLIENT

ST. JOHN'S
 DEPARTMENT OF ENGINEERING

PROJECT TITLE

OLD TOPSAIL ROAD TRAFFIC CALMING

SHEET TITLE

OLD TOPSAIL ROAD PLAN - 5

PROJECT NO.

12026

DRAWN BY

MEWC

CHECKED BY

KHH

DATE

MAY 2012

DRAWING NO.

C6

SCALE

1 : 250